



## Springfield Close Stanmore Offers over £350,000

A two bedroom, ground floor maisonette available chain free with Davidson Frost-Wellings.

The property is accessed via its own front door and has a spacious, bay windowed reception room, with high ceilings and a feature fireplace. There is also a separate galley kitchen, large master bedroom, additional double bedroom and a family bathroom with separate guest WC.

This maisonette further benefits from its own, private, rear garden.

Leasehold with 110 years remaining.  
Service charge nil.  
Ground rent of £70 per annum.  
Harrow Council tax band C.

### Viewing

Please contact our Davidson Frost-Wellings Office on 020 8954 8806 if you wish to arrange a viewing appointment for this property or require further information.

- Two bedrooms
- Private garden
- Ground floor maisonette
- Chain free
- Separate kitchen
- Leasehold

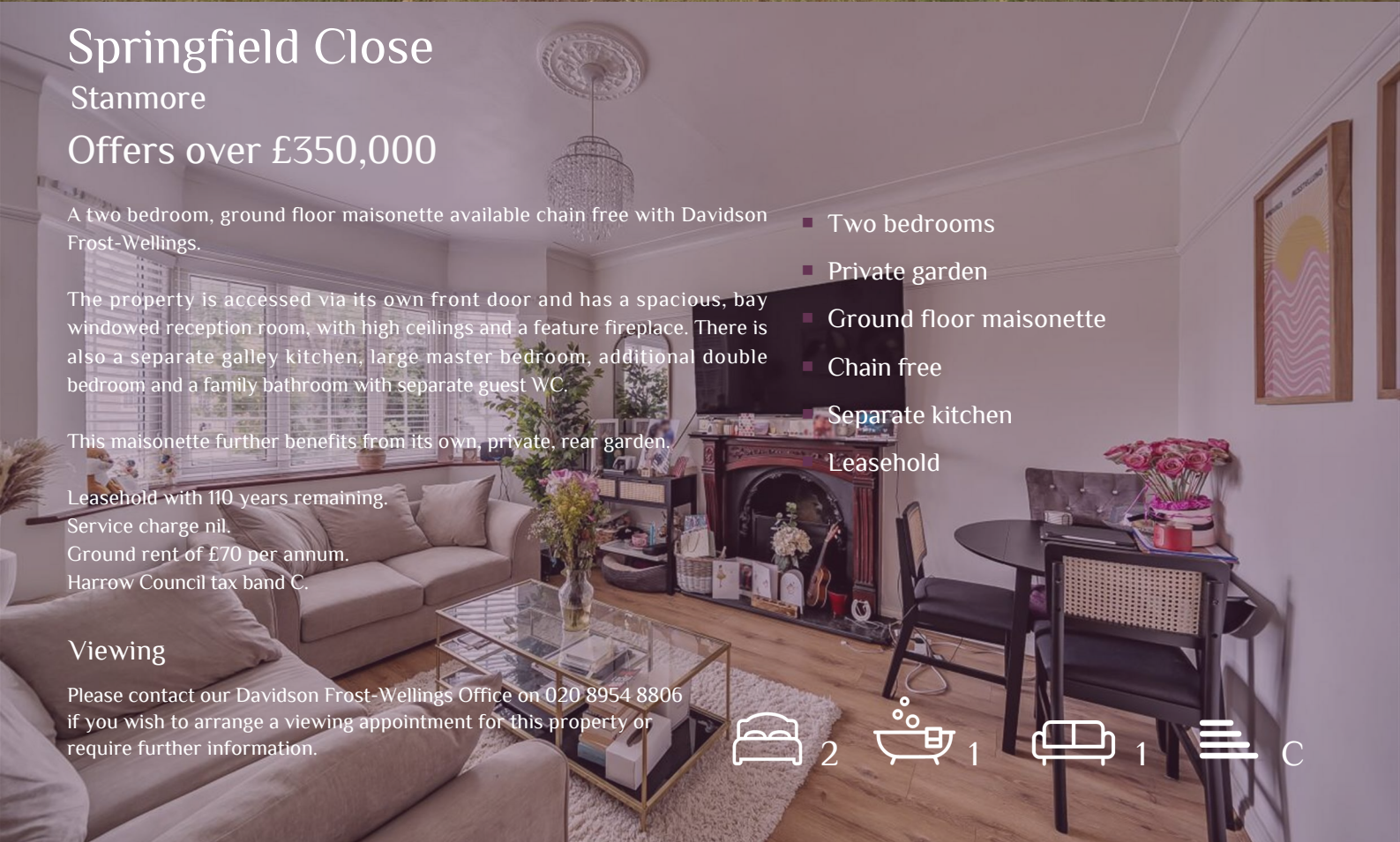

Floor Plan

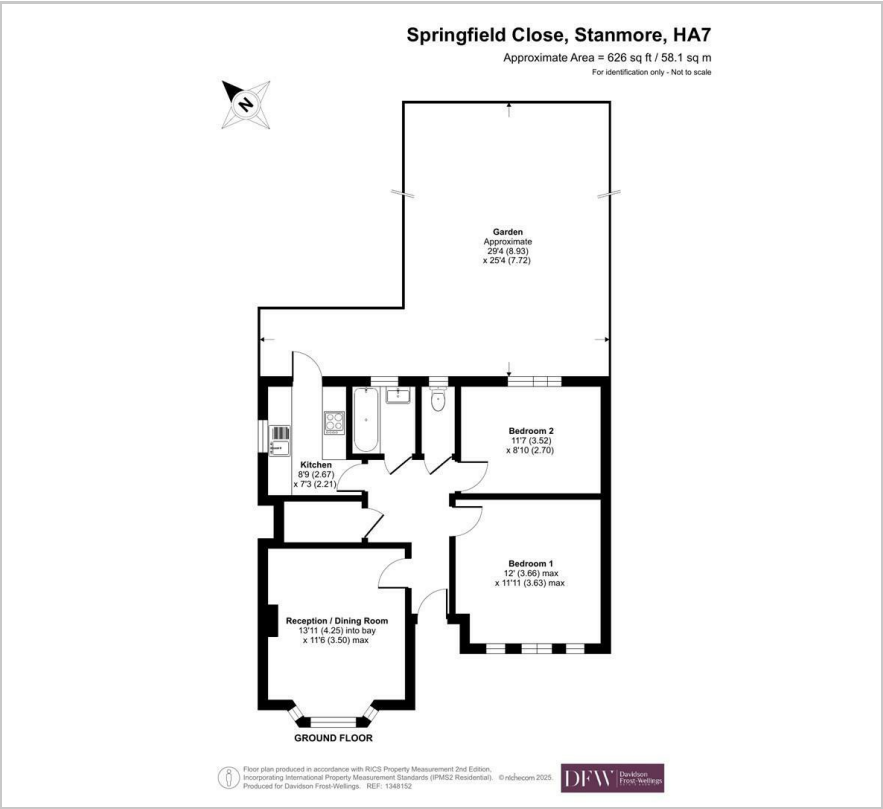

Area Map

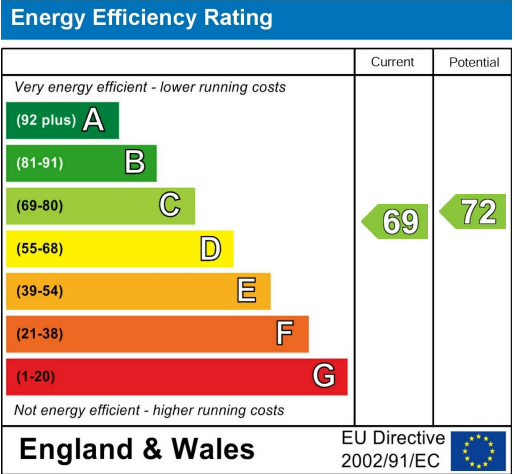

These particulars, whilst believed to be accurate are set out as a general outline only for guidance and do not constitute any part of an offer or contract. Intending purchasers should not rely on them as statements of representation of fact, but must satisfy themselves by inspection or otherwise as to their accuracy. No person in this firms employment has the authority to make or give any representation or warranty in respect of the property.